

# Script Lounge | Indiana FURNITURE

## Bistro Table Assembly Instructions

- 1 Determine the desired layout of units.
- 2 Take the "L" bracket and slide onto the brackets already attached to the back of the unit.

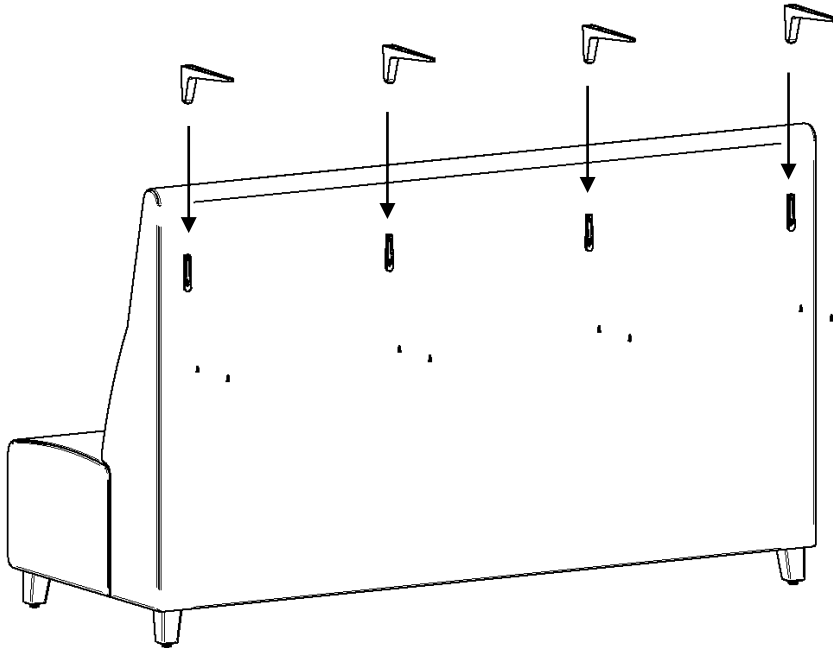

- 3 Place the table on the brackets and center left-to-right on the unit.

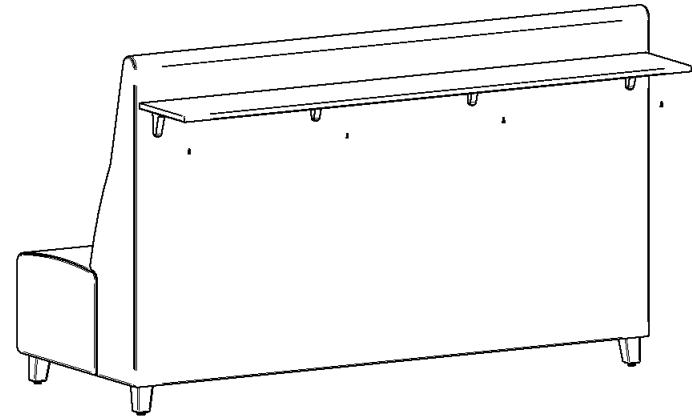

- 4 Pushing the table against the back of the unit so no gap is left between the table and the fabric, insert the #12 flat head screws into the brackets and into the table.

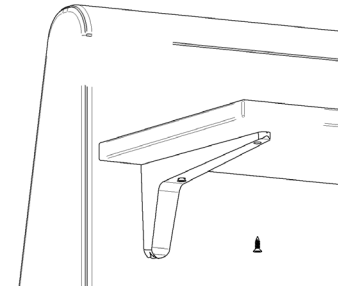

Note: Images shown are for clarity purposes only and may not match the unit that you are currently installing.

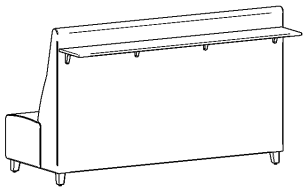

# Script Lounge | Indiana FURNITURE

## Bistro Table Assembly Instructions

- 5** Once all the #12 screws are put into place, locate the two "L" brackets and #8 x 5/8 Phillips Pan Head screws.

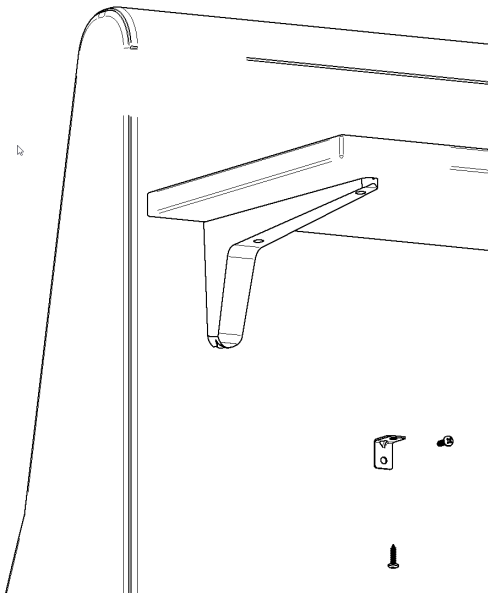

- 6** Without applying too much torque, attach the "L" brackets to the underside of the table and to the back of the unit utilizing the #8 screws.

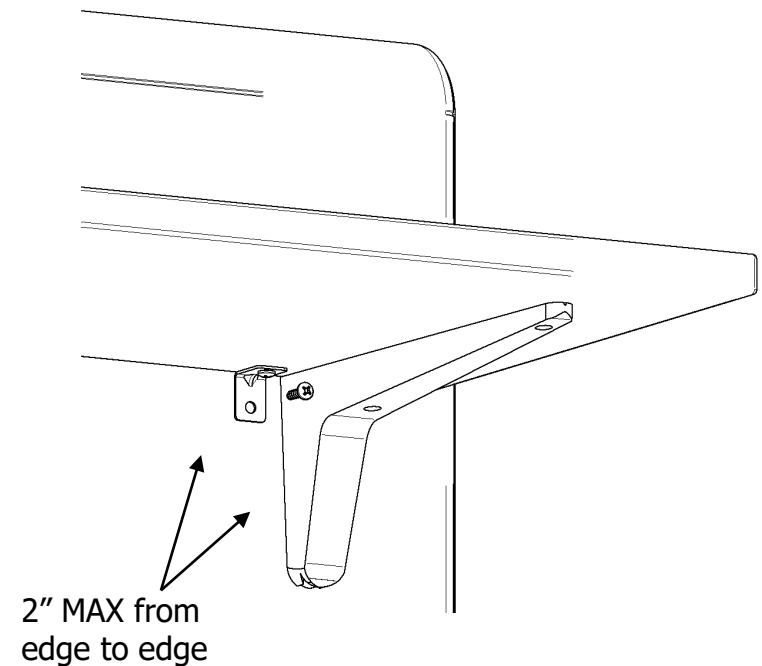

Note: Images shown are for clarity purposes only and may not match the unit that you are currently installing.