

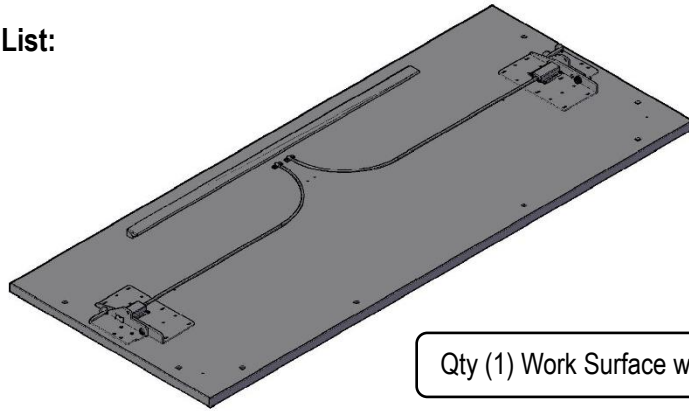

1) (5010

Parts List:



Qty (1) Work Surface with Flip Mechanism

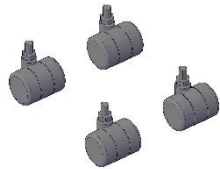

Qty (4) Castors

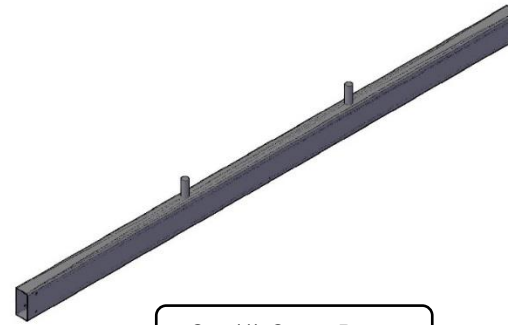

Qty (1) Cross Beam

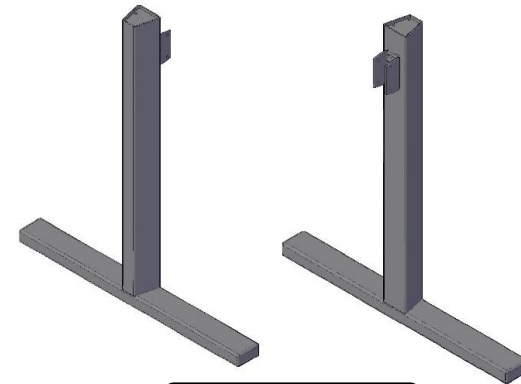

Qty (2) T-Legs

- Hardware Included**
- (14) #12 x 1" Pan Head Wood Screws
 - (8) 1/4"-20 x 3/4" Button Head Cap Screw
 - (8) 1/4" Star Washers
 - (8) 1/4"-20 x 3/4" Flat Head Cap Screw

- Tools Required**
- Drill with phillips screw bit
 - 5/32" Allen Wrench
 - 1/2" Wrench

Step 1: Using the (2) T-Legs, Cross Beam and the 1/4"-20 x 3/4" Button Head Cap Screws assemble the Cross beam to the T-Legs.

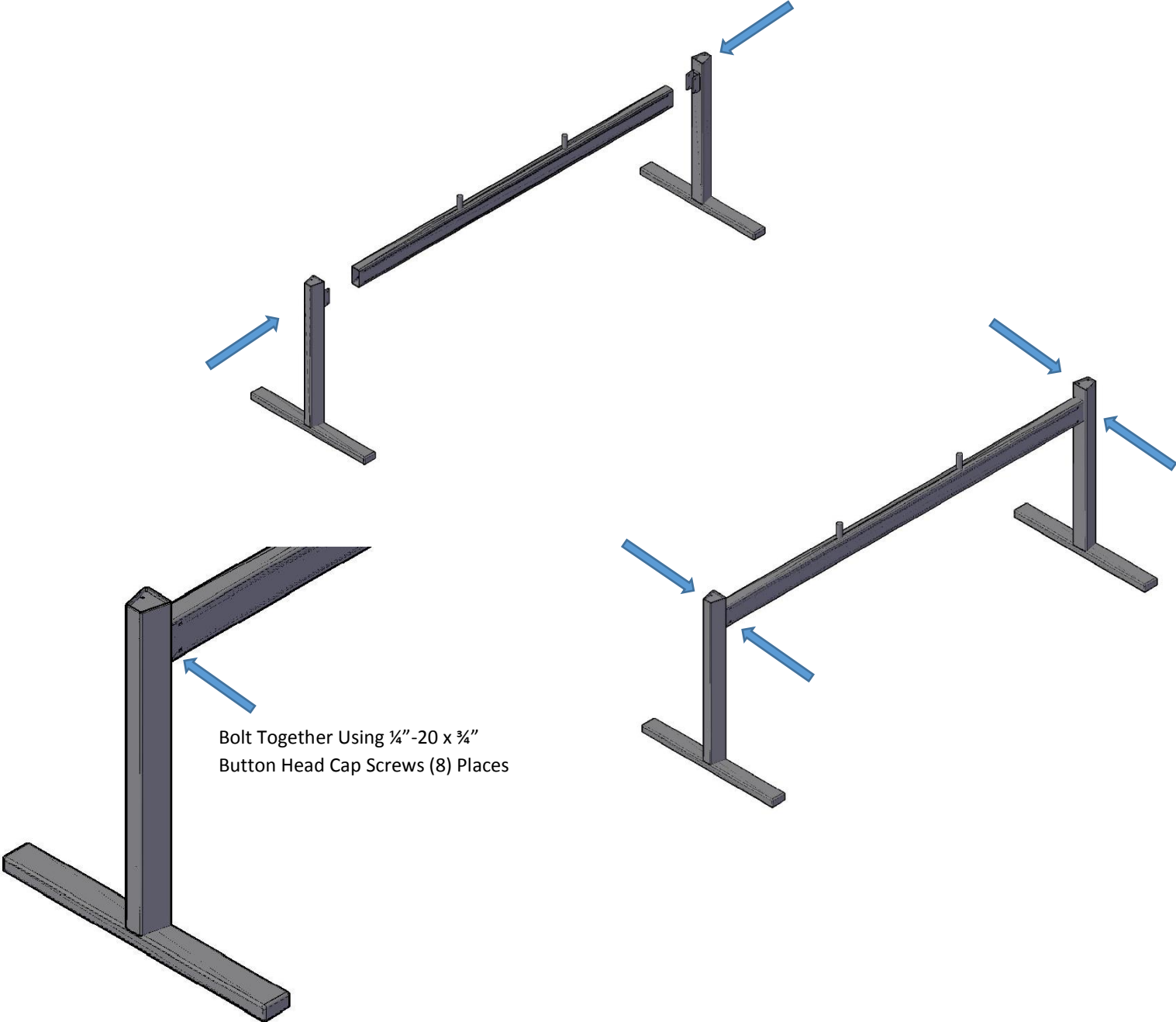

Step 2 : Next, activate the flip mechanism by rotating the lever bar to rotate the top plates.

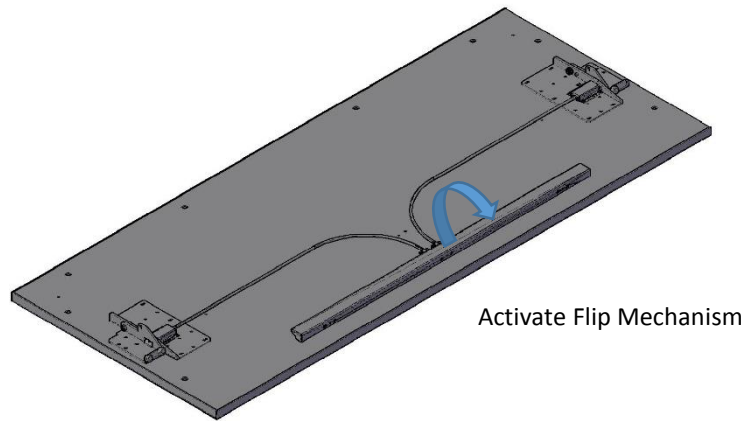

Activate Flip Mechanism

Rotate Top Plates by hand

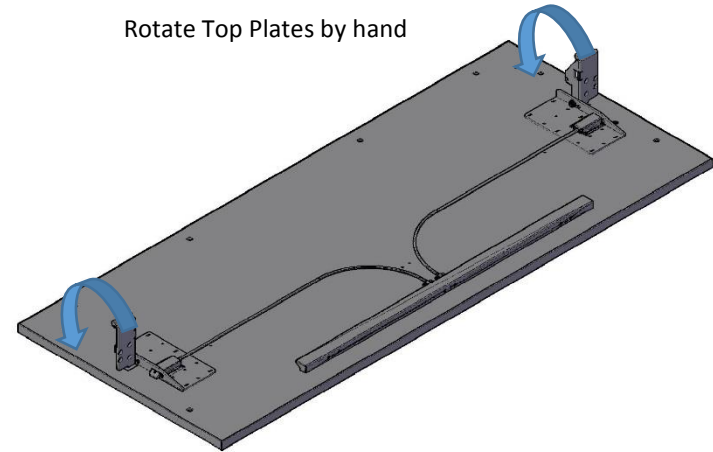

Step 3 : Next, Bolt the top plates on the legs with using the (8) $\frac{1}{4}$ "-20 x $\frac{3}{4}$ " Flat Head Cap Screw and the $\frac{5}{32}$ " Allen Wrench.

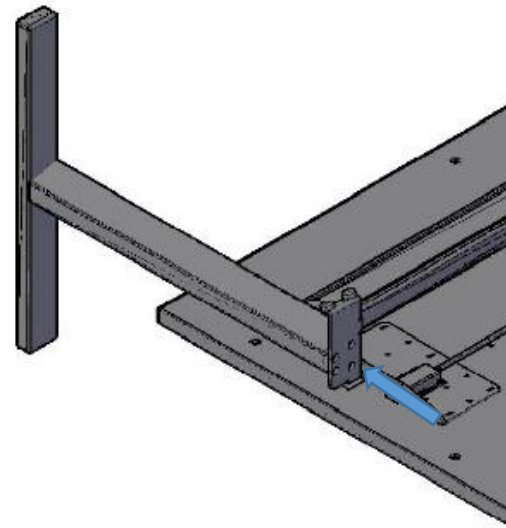
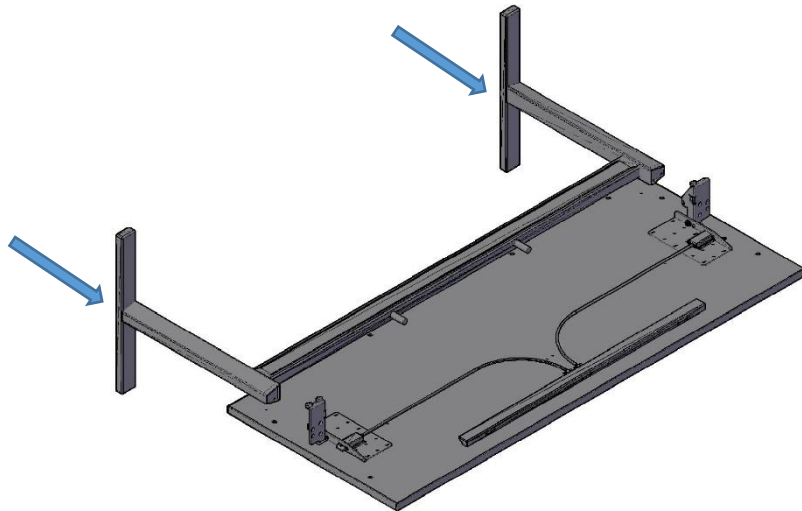

Install Flat Head Cap Screws, (4) Per Leg

Step 4 : Now, tighten up the 8 screws in the latch plate going into the top.

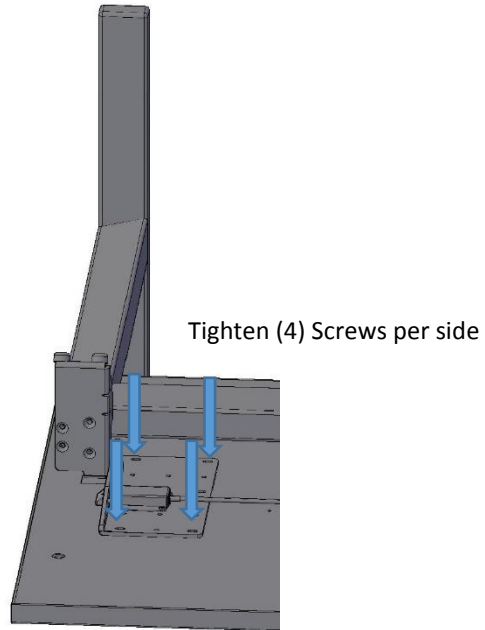

Step 5 : Next, using the provided #12 x 1" Pan Head Wood Screws install the remaining 14 screws in the Latch Plate

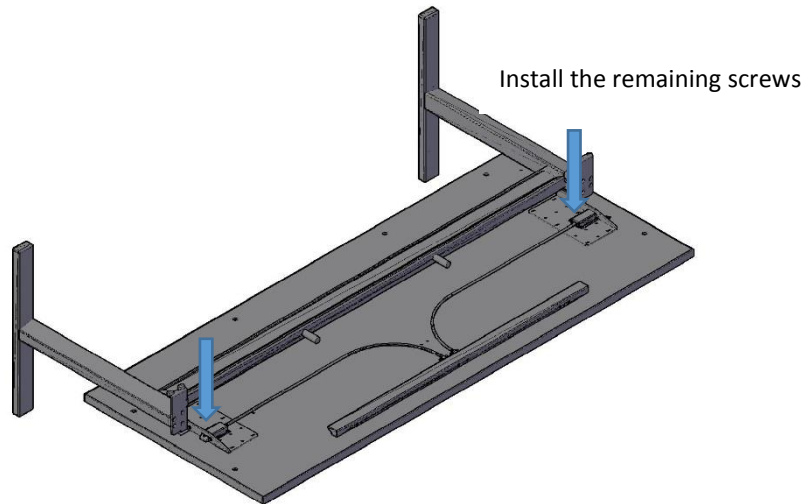

Step 6 : Screw the (4) Castors provided in to the T-Legs with a ½” Wrench. Next turn the table over and you are finished!

