

Assembly Instruction

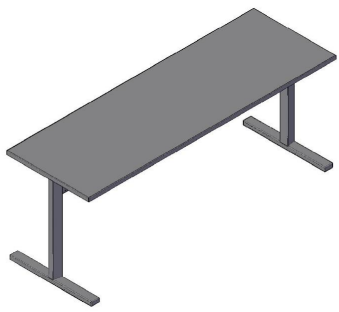

Parts List:

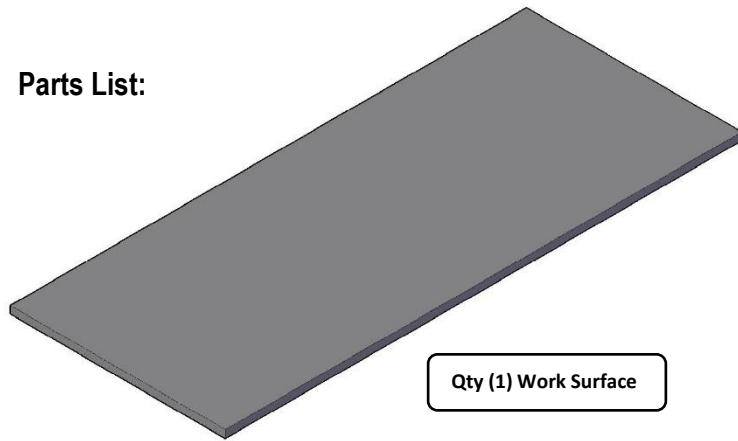

Qty (1) Work Surface

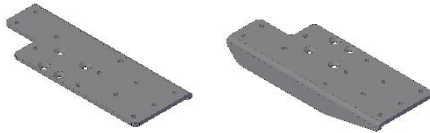

Qty (2) Top Plates

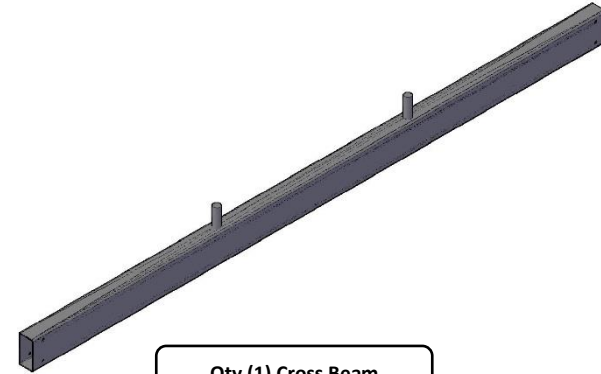

Qty (1) Cross Beam

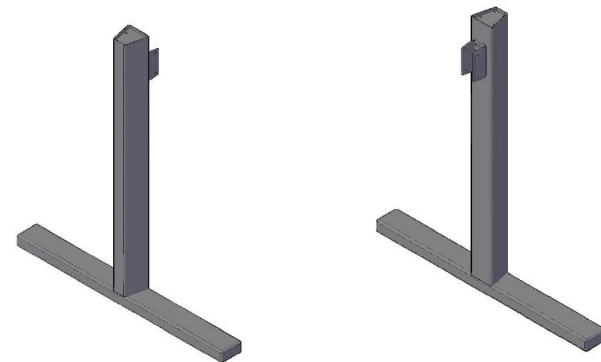

Qty (2) T-Legs

Hardware Included

- (24) #12 x 1" Pan Head Wood Screws
- (8) 1/4"-20 x 3/4" Button Head Cap Screw
- (8) 1/4" Star Washers
- (8) 1/4"-20 x 3/4" Flat Head Cap Screw

Tools Required

- Drill with phillips screw bit
- 5/32 Allen Wrench

Assembly Instruction

Step 1: Using the (2) T-Legs, Cross Beam and the $\frac{1}{4}$ "-20 x $\frac{3}{4}$ " Button Head Cap Screws assemble the Cross beam to the T-Legs.

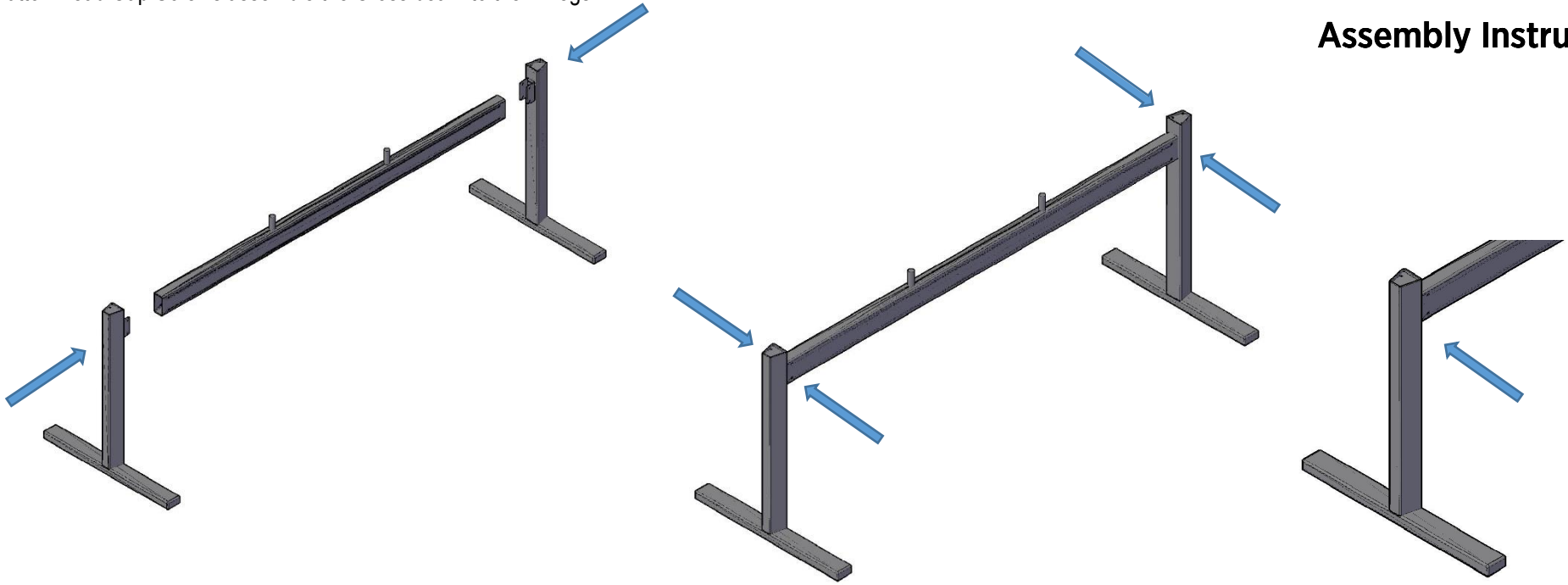

Step 2 : Next, Bolt the top plates on with using the $\frac{1}{4}$ "-20 x $\frac{3}{4}$ " Flat Head Cap Screw

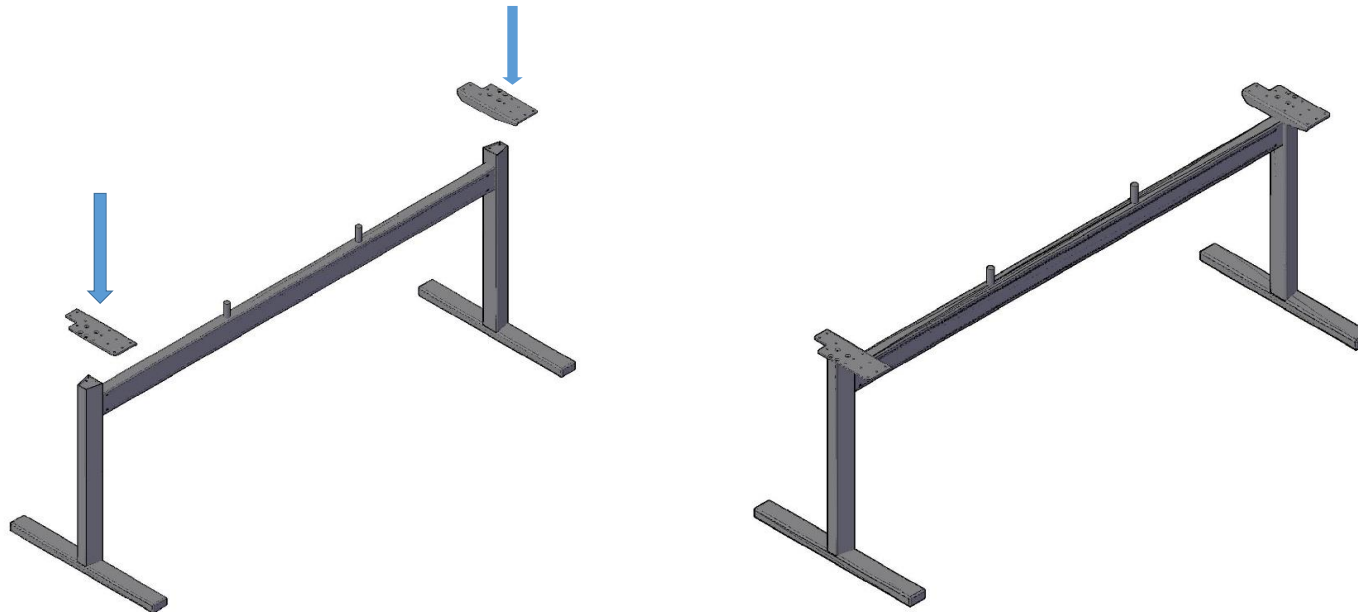

Assembly Instruction

Step 3 : Finally, fasten the work surface to the T-Leg assembly using the Qty(24) #12 x 1" Pan Head Wood Screws.

There will be location holes for (4) of the Screws. Next Adjust the levelers if needed for leveling the work surface.

You are finished!

Note: Fasten the T-Leg Assembly with the Work Surface on the floor.

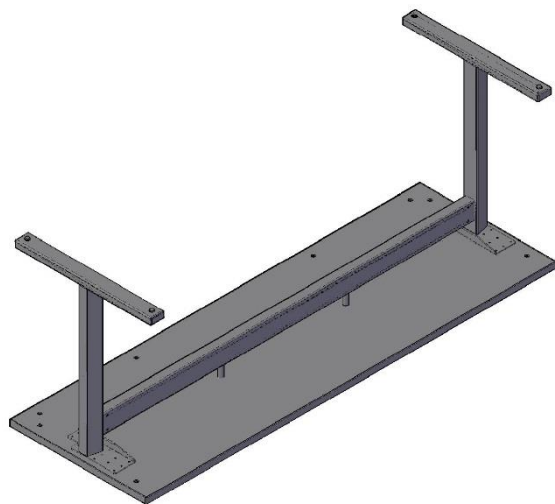
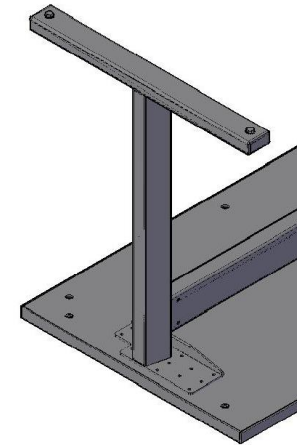
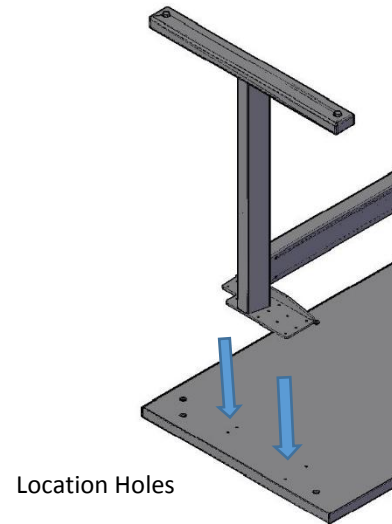
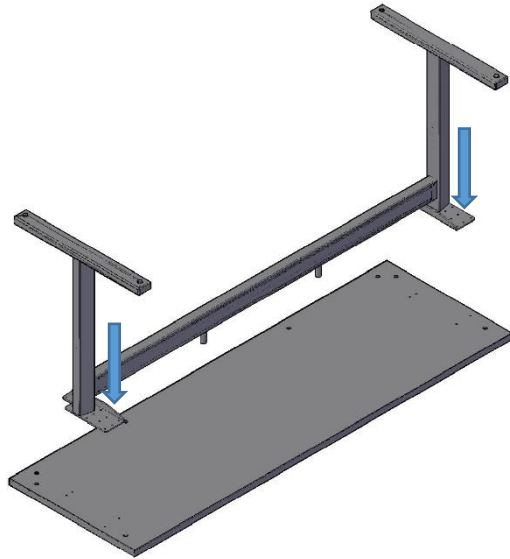

Adjust the Levers and
you are finished!

