

# Arlington Casegoods

## Technical Specifications

### Construction & Materials

- Veneer:** Exposed surfaces feature select grade, plain sliced American Black Walnut and Cherry hardwood veneers, carefully selected and matched to assure proper balance and consistency. Our veneer features UV Advantage, an ultra-violet finish, on all exposed surfaces by utilizing roll-coat UV technology
- Laminate:** High-Pressured Laminate (HPL) tops are made of woodgrain laminates fused to particleboard core. Each laminate offers lasting beauty, superior resistance to normal wear, and easy maintenance.
- Tops:** 1 ½" thick. Wood Veneer worksurfaces are 5-ply balanced construction with solid hardwood rims; HPL worksurfaces are 3-ply balanced construction with solid hardwood rims. Worksurfaces feature shaped edge profiles on all four sides and grain direction runs left to right, unless otherwise noted.
- Chassis:** Veneer Chassis is constructed of American Black Walnut or Cherry hardwood veneer. Chassis is securely fastened using high quality European fastening systems and heavy-duty, 16-gauge joining brackets to assure maximum strength. All units ship with heavy-duty, adjustable leveling glides to ensure proper leveling and compensation for uneven floors.
- Drawers:** Box and file drawers are tested for 100lb capacity, lateral files are tested for 200lb capacity. 5-sided drawer construction for easy removal of drawer fronts. Drawer fronts are 3-ply construction, ¾" thick with matched grain while sides, back, and front are ½" thick woodgrain vinyl-wrapped miter fold construction. Box and file drawers have ½" thick hardboard bottoms, while lateral file drawers feature ¼" thick bottoms. Box and file drawers have full extension, progressive action slides with precision steel ball bearings. All suspensions have a limited lifetime warranty.
- Filing:** All file drawers are standard with filing systems designed to accommodate a variety of filing requirements. Legal and letter width file drawers provide legal front to back, and letter or legal side to side.
- Storage:** All hinged doors include soft close hinges. Soft close hinges reduce stress placed on the cabinet when the door is closed and offers a quiet closure.
- Locking:** Central locking is standard on all desks. Lock core is available in black or silver. Removable lock cylinders allow for units to be re-keyed at a later date if required. Units are shipped randomly keyed as standard. Keyed alike units available upon request at no additional charge.
- Cord Mgmt:** Grommets are standard in back panels of assembled returns, bridge units, kneespace credenzas, and hutch units. A grommet is standard in tops of corner units. Grommets may be ordered in the tops of desks, returns, bridge units, credenzas, and component worksurfaces and are available in black or silver. Undersurface tracks are available for additional cord management.

### Features

- Arlington offers all the grace and embellishments associated with traditional styling...with an added emphasis on value.
- Finely crafted in select American hardwood veneers, Arlington ensures quality and expert craftsmanship.
- Arlington features a veneer chassis with your choice of either a veneer or HPL top.
- Arlington's elegant edge profile coordinates with your choice of five pull options, including Arlington A (ARA, Antique Brass) or B (ARB, Antique Brass), Wilmington (WLM, Antique Brass), Jefferson (JEF, Antique Brass) or Liberty (ALB, Silver).
- Two options of Base and Optional Decorative molding (Arlington and Wilmington) are skillfully applied by hand to add timeless sophistication.
- Select height adjustable units feature one or two worksurface height adjustability, two switch options with three programmable stand
- reminders and four height position memory, and wire management options. A full range of storage and filing options provides the ability for personalizing each setting to fit individual needs.
- Easily add grommets, power, and data to increase the functionality of your workstation.
- A holistic surface materials palette, featuring veneer finishes, woodgrain laminates, and more.
- 12 Year Warranty (some exclusions may apply, see Full Warranty in Price List).
- Units ship fully assembled.

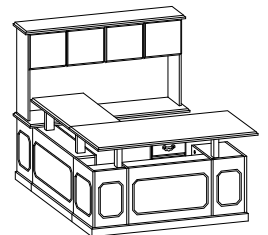
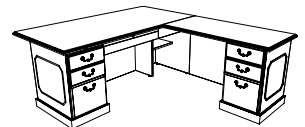

### Certifications & Compliance

- Intertek Sustainability Certified for compliance with VOC emission concentrations
- BIFMA level® Certified for environmentally-preferable and socially-responsible office furniture
- BIFMA Compliant® Certified for meeting mechanical standards that focus on safety and durability
- TSCA Title VI (Formerly CARB) Compliance
- Contribution to U.S. Green Building Council's LEED Program



Indiana  
FURNITURE