

Blade One 10: 2 Piece Standard Conference Table Assembly Instructions 96" to 120" Lengths

Parts List:

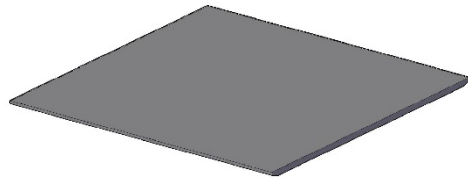

Qty (2) Tops

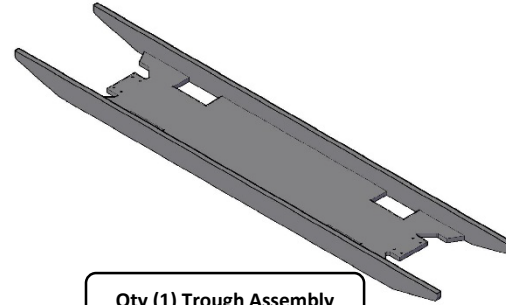

Qty (1) Trough Assembly



Qty (2) Jointer Plates



Qty (4) Jointer Bolts



Qty (4) Short L-Brackets

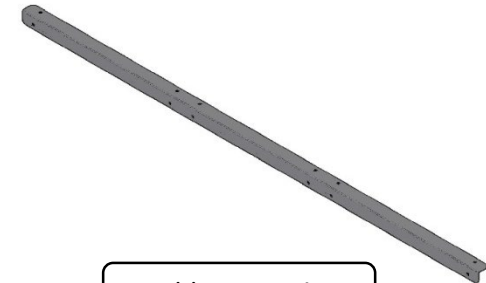

Qty (2) Long L-Brackets



Qty (4) Small Angle Brackets



Qty (2) Large L-Brackets

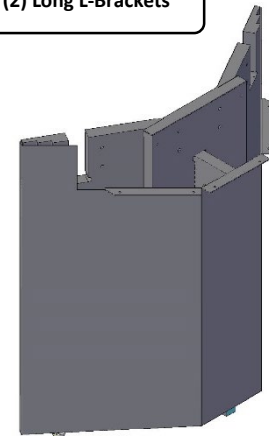

Qty (2) Bases

Hardware Included

- Bag of #10 x 3/4" Pan Head Screws
- Bag of 1/4"-20 x 2" Bolt and 1/4"-20 Nuts
- (8) 1/4"-20 x 1-3/4" Button Head Bolt, 1/4"-20 Nuts and 1/4" Star Washers
- (16) #8 x 5/8" Pan Head Screws
- Velcro (For Metal Base Covers)

Tools Required

- (2) People
- Drill with phillips screw bit
- $\frac{5}{32}$ " Allen Wrench
- 5mm Allen Wrench
- 7/16" Wrench
- Level

2298-1102P96120KR1

Step 1: Remove the accent cover off of the bases by pulling it off. Next, Using the supplied Velcro with Self-Stick Adhesive on it, Place the Velcro on the outside of the base and on the inside of the accent cover along the length of the vertical edge

Base with Accent Cover

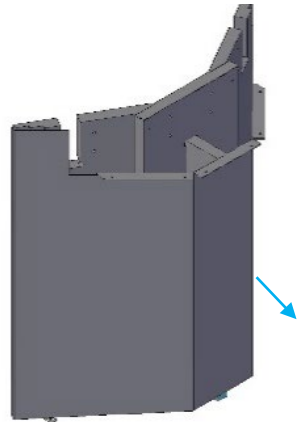

Base with Accent Cover Removed

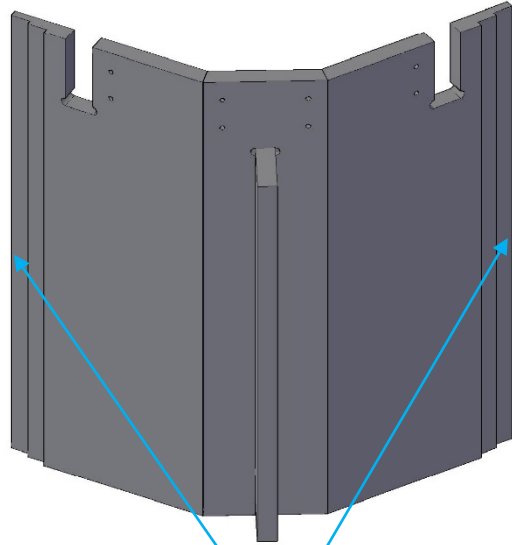
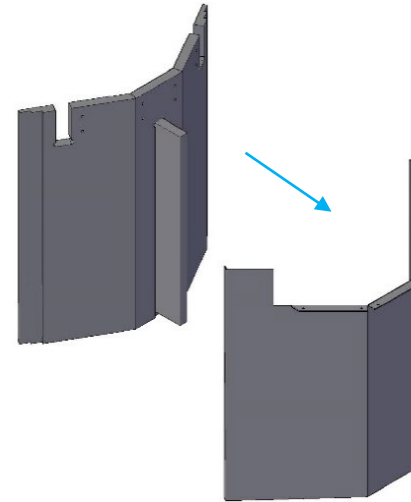

Attach Velcro here

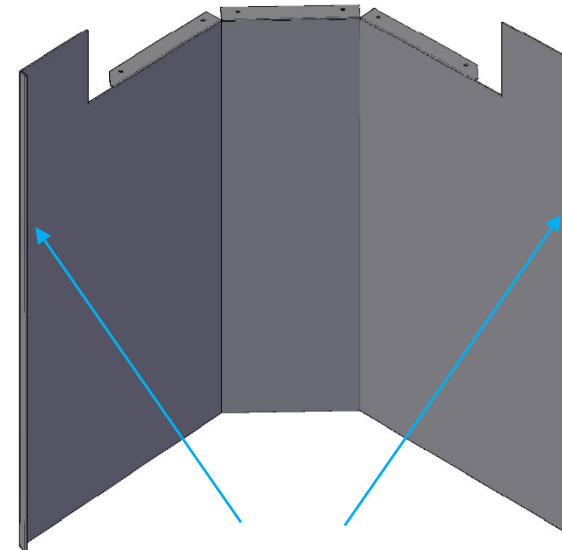

Attach Velcro here

Step 2: Bolt together the (2) Bases to the Trough assembly using the 1/4"-20 x 2" Bolts , 1/4" -20 x 1-3/4" Bolts, 1/4"-20 Nuts, Large L-Brackets, Small Angle Brackets, and #8 x 5/8" Pan Head Screws

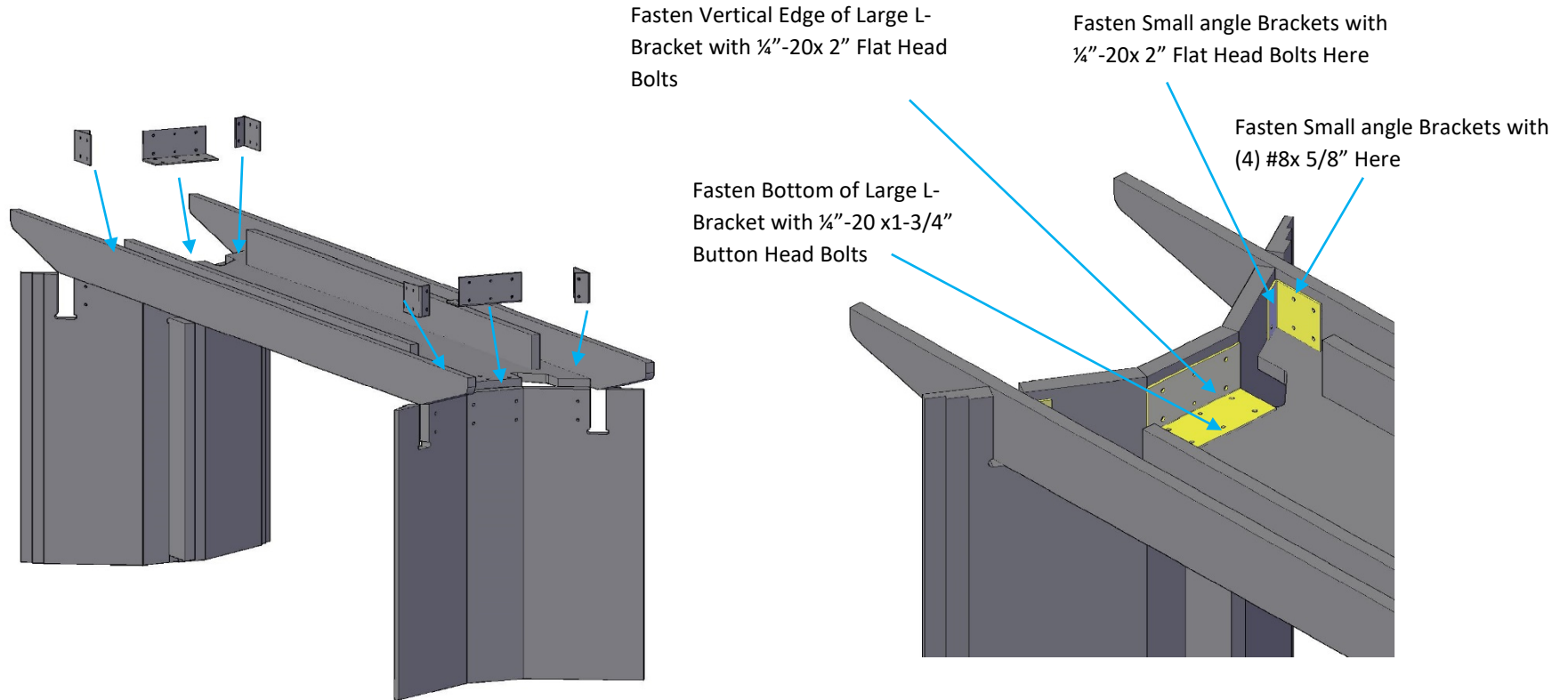

Step 3: Attach the Short L- Brackets and the Long L-Brackets to the Trough using the Silver #10 x 3/4" Pan Head Screws Evenly Spacing Long L-Brackets.

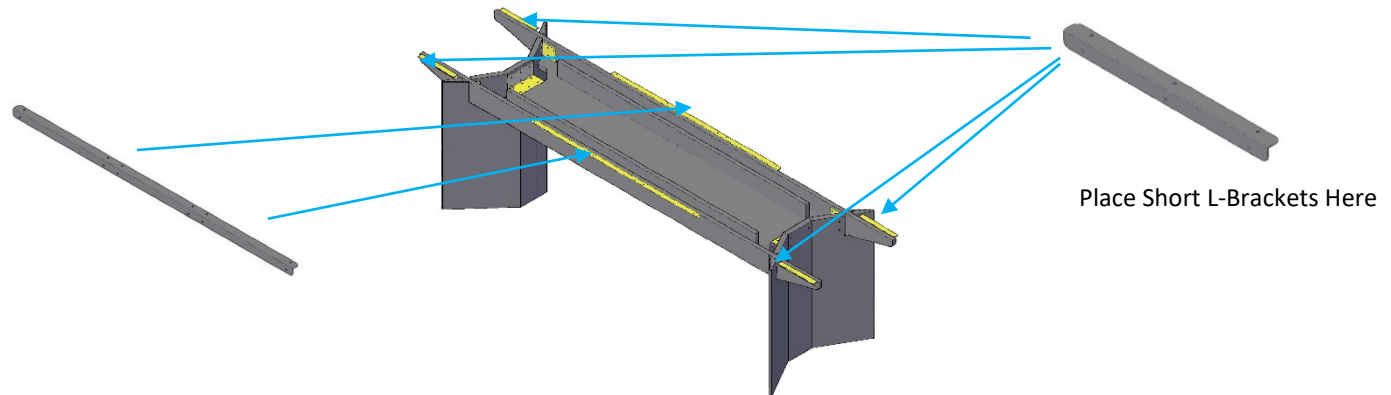

Step 4: Next, using the supplied Joints Bolts and a 7/16" Wrench, attach the two tops together. Then attach the Joints Plates to the work surfaces with #10 x 3/4" Pan Head Screws.

(Note: Do Not Attach the Tops to the L-Brackets at this time!)

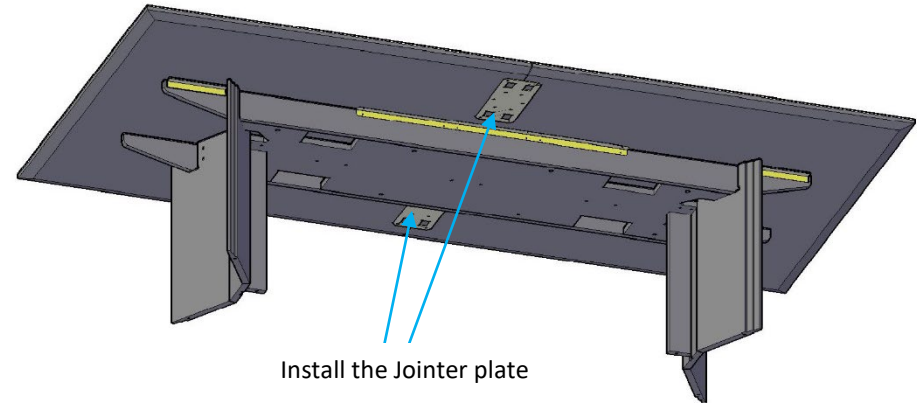
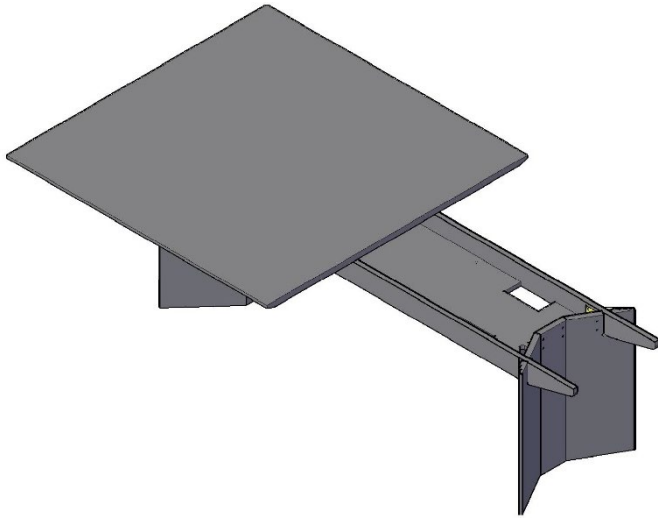

Jointer Bolt

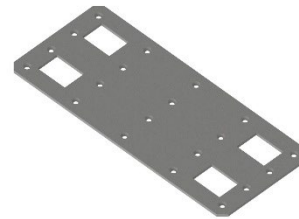

Jointer Plate

Step 5: Center the top on the trough assembly and attach the tops to the L-Brackets using the #10 X 3/4" screws.

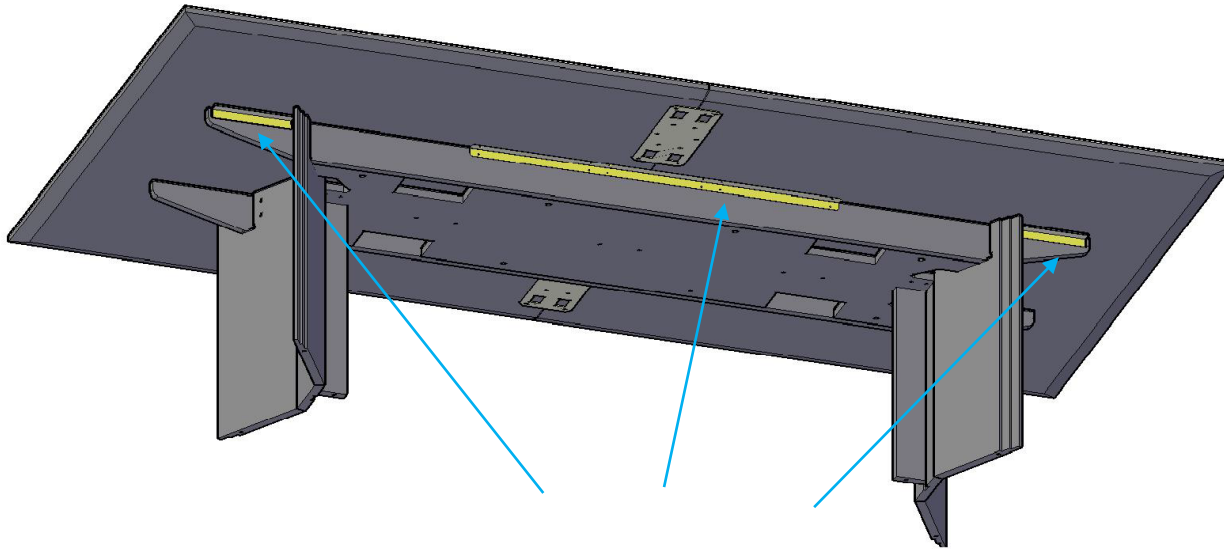

Fasten the Tops with #10 x 3/4" screws

Step 8: Level the table using the 5mm Allen Wrench. Next (If Applicable) install all power ports and route wires down the base. Lastly, When the Table is completely wired, install the Base Covers. Once the base covers are installed, using the Silver #10 x3/4" screws, fasten the covers to the underside of the trough.

