

Blade One 10: 2 Piece Standard Top Conference Table Assembly Instructions 144" to 192" Lengths

Parts List:

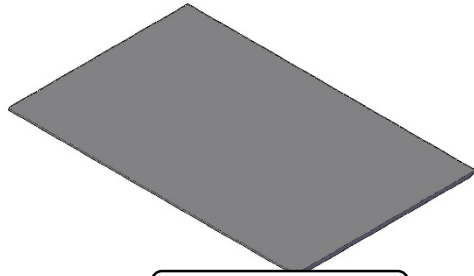

Qty (2) Tops

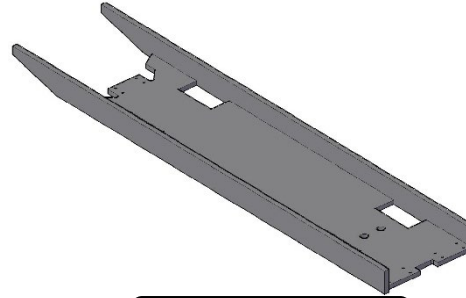

Qty (2) Trough Assembly

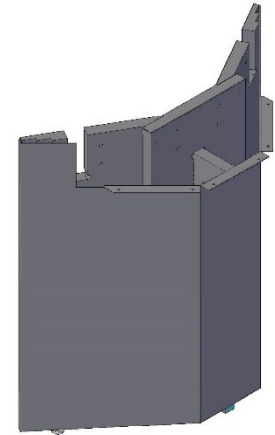

Qty (2) Bases

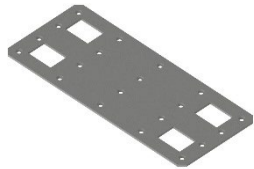

Qty (2) Jointer Plates



Qty (4) Jointer Bolts



Short L-Brackets

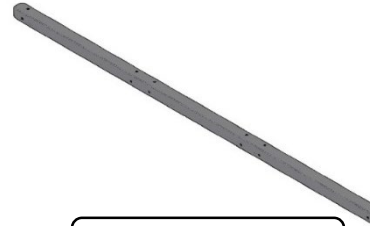

Long L-Brackets



Qty (4) Small Angle Brackets



Qty (4) Large L-Brackets

Hardware Included

- Bag of #10 x 7/8 " Flat Head Screws
- Bag of 1/4"-20 x 2" Bolt and 1/4"-20 Nuts
- (32) 1/4"-20 x 1-3/4" Button Head Bolt, 1/4"-20 Nuts and 1/4" Star Washers
- (16) #8 x 5/8" Pan Head Screws
- Velcro (For Metal Base Covers)

Tools Required

- (2) People
- Drill with phillips screw bit
- 5/32 Allen Wrench
- 5mm Allen Wrench
- 7/16" Wrench
- Level

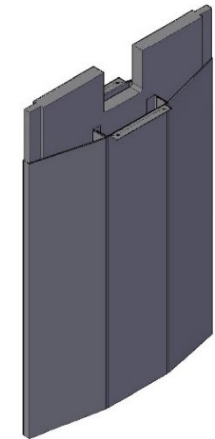

Qty (1) Mid-Base

2298-1102P144192KR1

Step 1: Remove the accent cover off of the bases by pulling it off. Next, Using the supplied Velcro with Self-Stick Adhesive on it, Place the Velcro on the outside of the base and on the inside of the accent cover along the length of the vertical edge

Base with Accent Cover

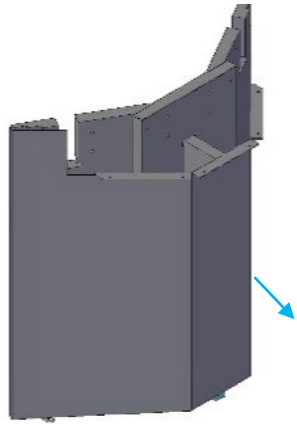

Base with Accent Cover Removed

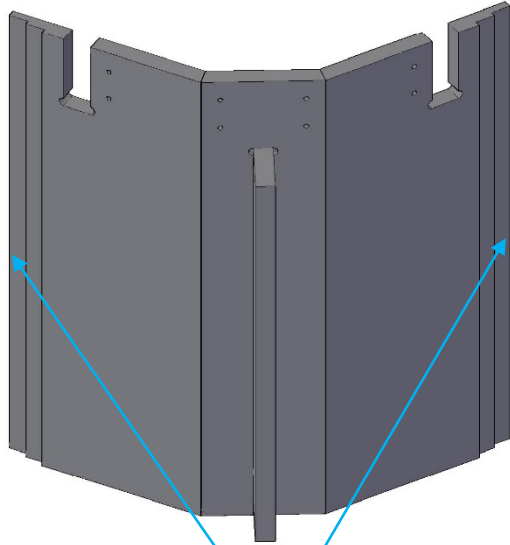
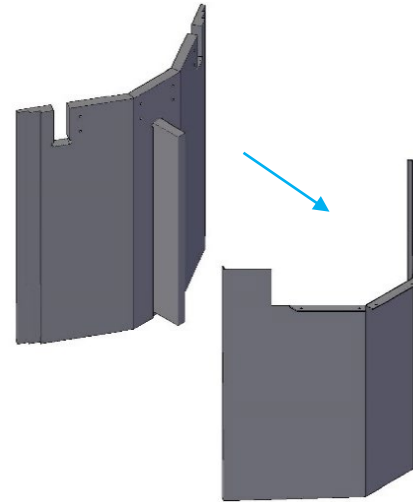

Attach Velcro here

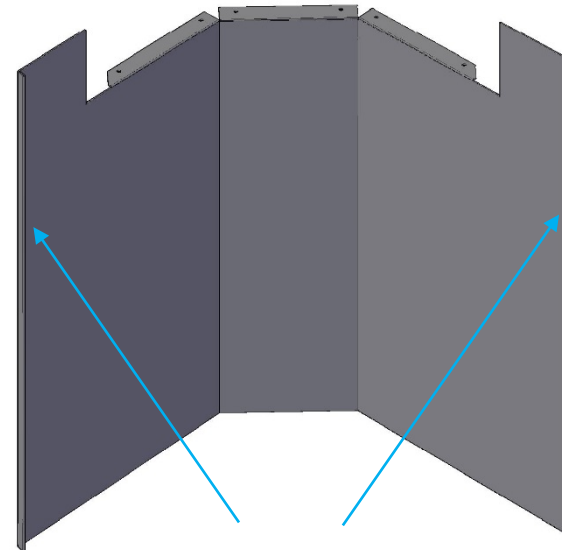

Attach Velcro here

Step 2: Bolt together the (2) Bases to the Trough assembly using the 1/4"-20 x 2" Bolts , 1/4" -20 x 1-3/4" Bolts, 1/4"-20 Nuts, Large L-Brackets, Small Angle Brackets, and #8 x 5/8" Pan Head Screws

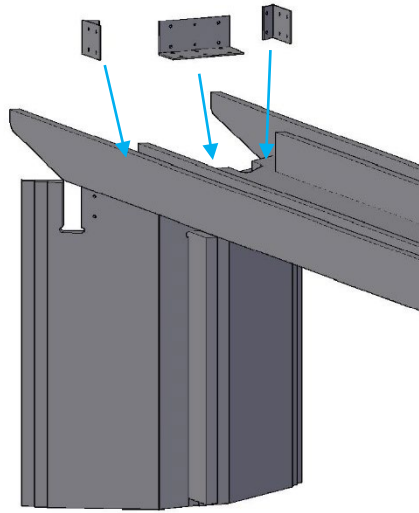

Fasten Vertical Edge of Large L-Bracket with 1/4"-20x 2" Flat Head Bolts

Fasten Small angle Brackets with 1/4"-20x 2" Flat Head Bolts Here

Fasten Bottom of Large L-Bracket with 1/4"-20 x1-3/4" Button Head Bolts

Fasten Small angle Brackets with (4) #8x 5/8" Here

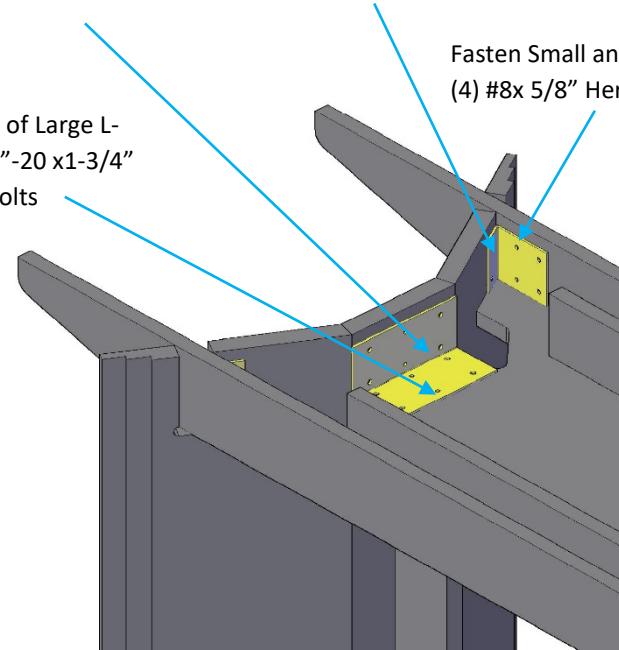

Step 3: Bolt together Mid base to the trough section using the Large L-Brackets with 1/4"-20 x 2" Flat Head Bolts

Fasten Vertical Edge of Large L-Bracket with 1/4"-20x 2" Flat Head Bolts

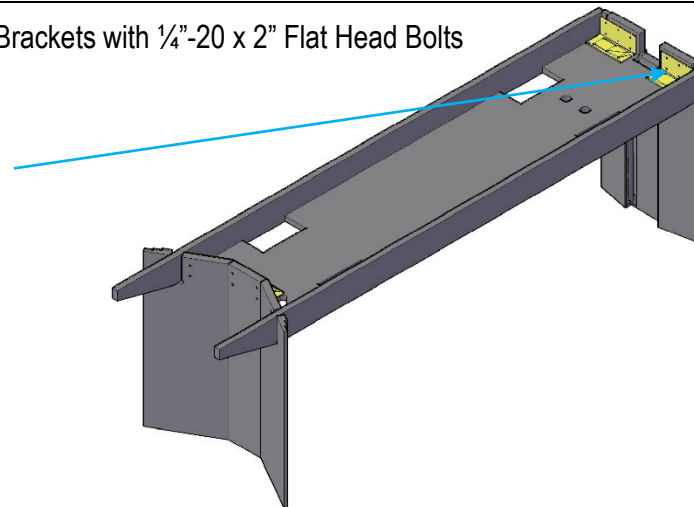

Step 4: Bolt together the remaining trough section to the Mid base along with the remaining Base. Also, install the Short L-Brackets and the Long L-Brackets to the trough section using the #10 x3/4" Pan Head Screws. Evenly space the Long L-Brackets.

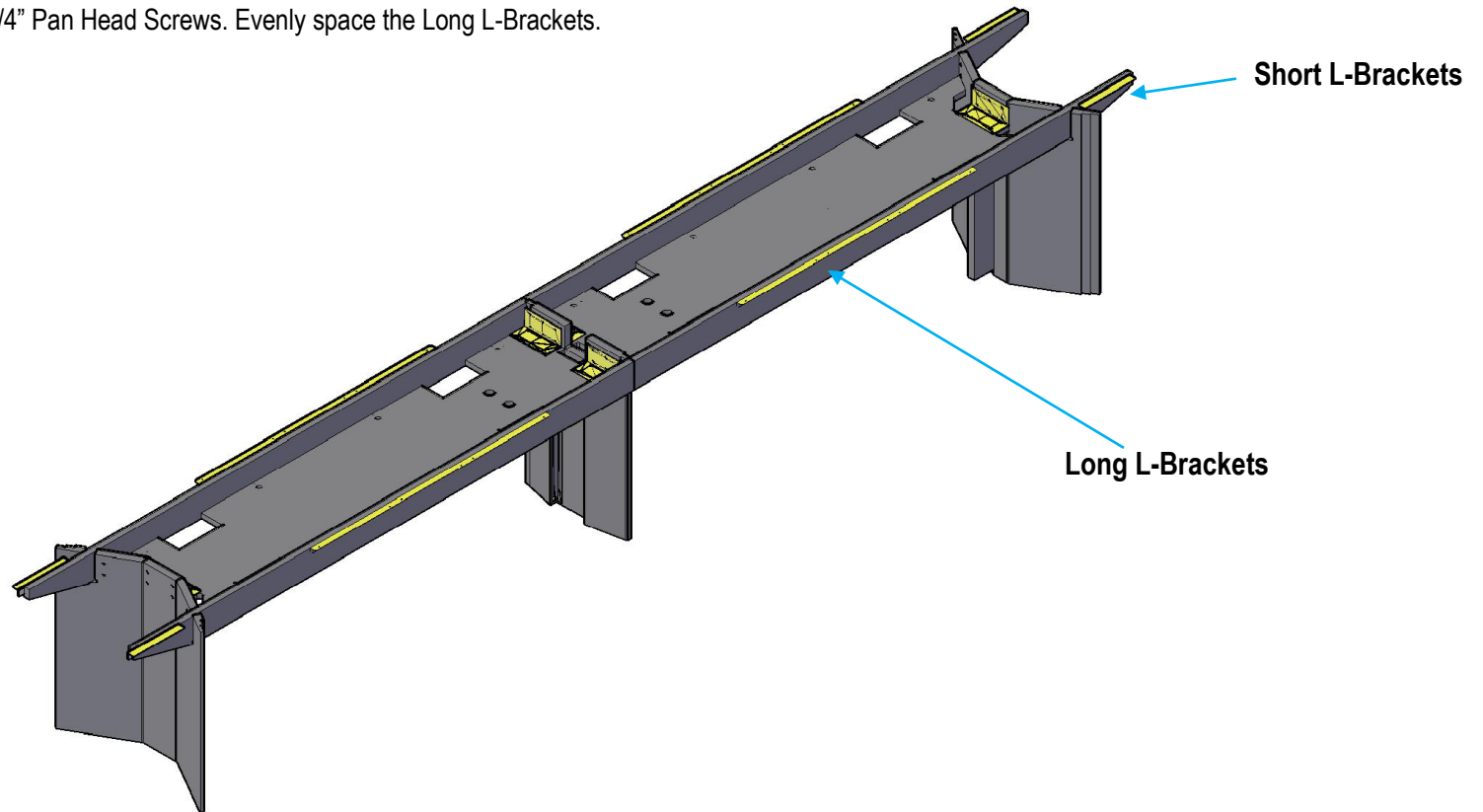

Step 5: Using the supplied Joints Bolts and a 7/16" Wrench, fasten the tops together (**Note: Do not attach the tops to the L-Brackets at this time!**)

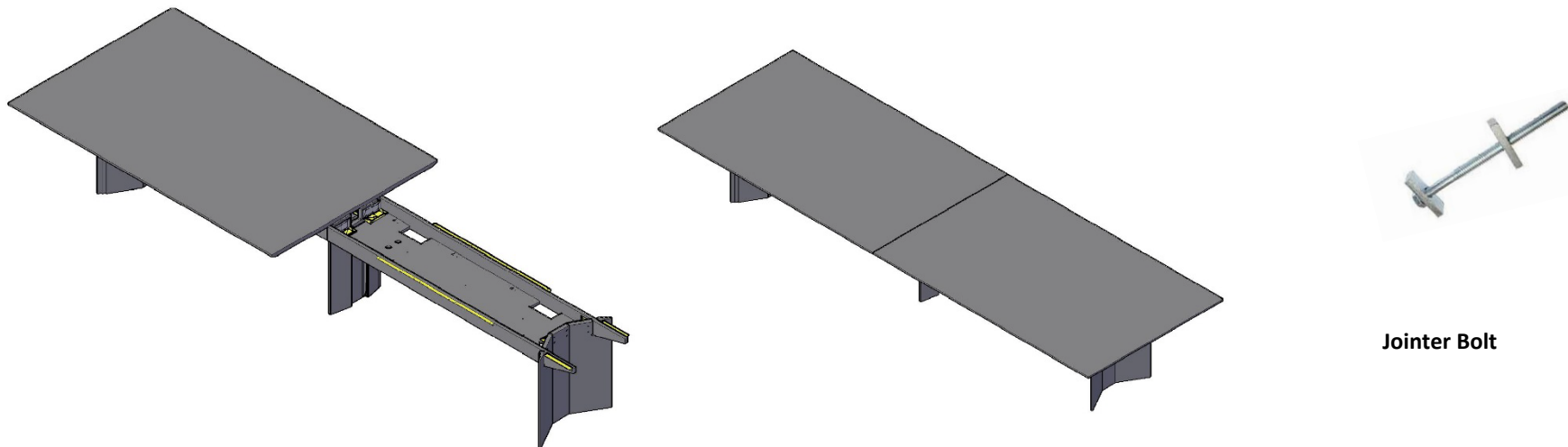

Step 6: Next, Using the #10 X 3/4" screws, fasten the Joints plates to the tops.

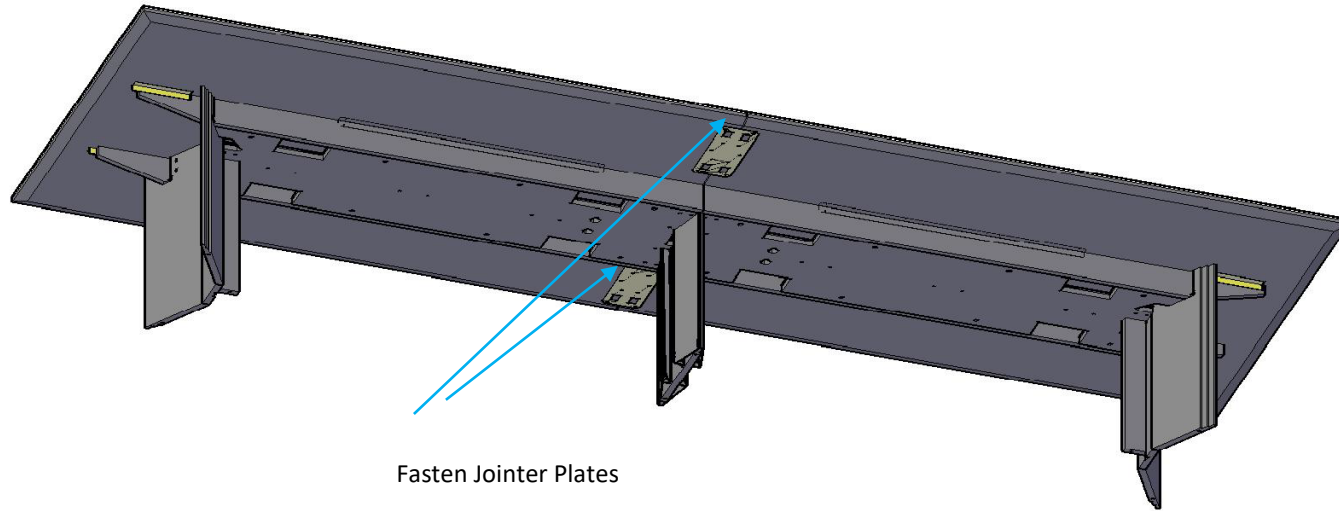

Step 7: Now, fasten the tops to the L-Brackets using the #10 X 3/4" screws.

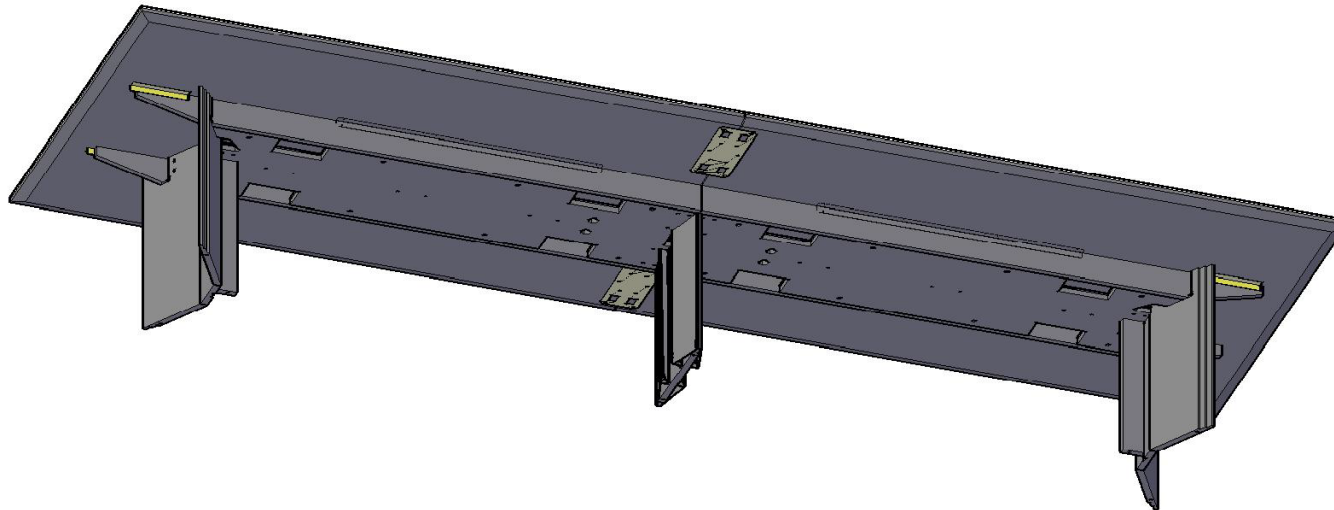

Step 8: Level the table using the 5mm Allen Wrench. Next (If Applicable) install all power ports and route wires down the base.

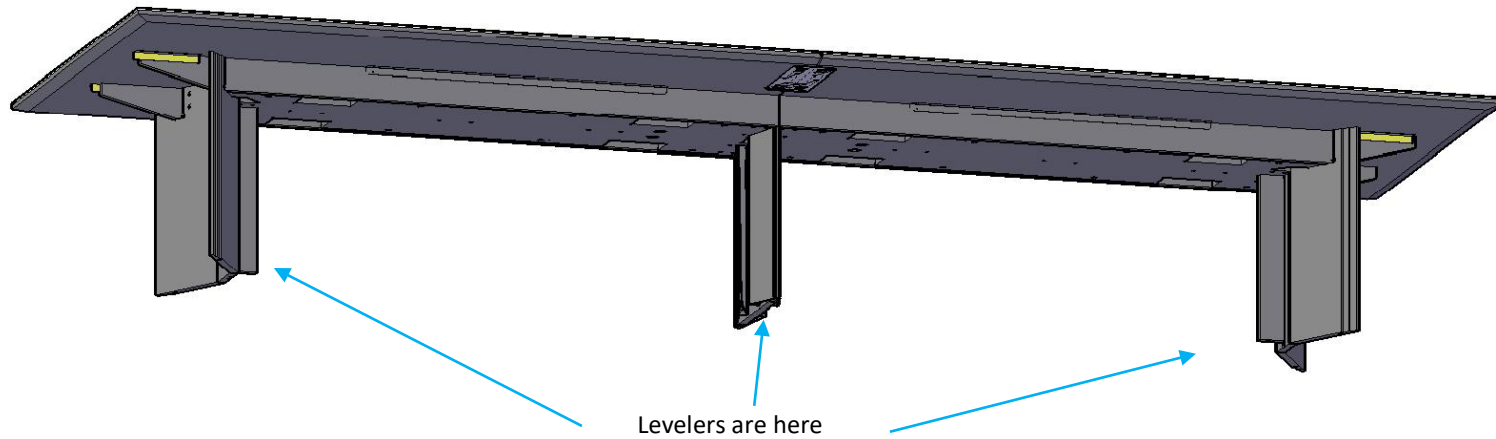

Step 13: When the Table is completely wired, install the Base Covers. Once the base covers are installed, using the Silver #10 x 3/4" screws, fasten the covers to the underside of the trough.

